

AMA03016 - 16 ft manwalk

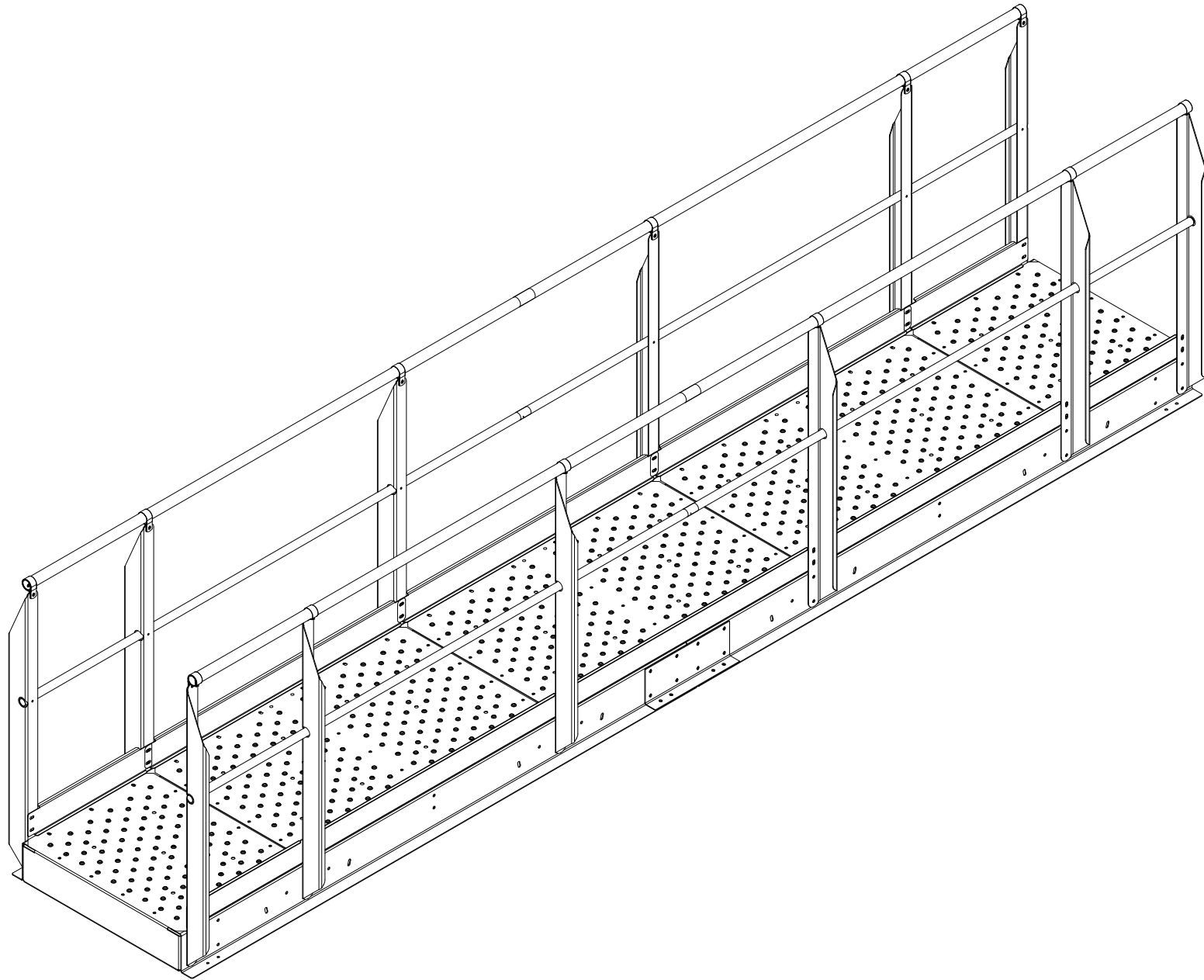

Parts break down AMA03016

AM-06096

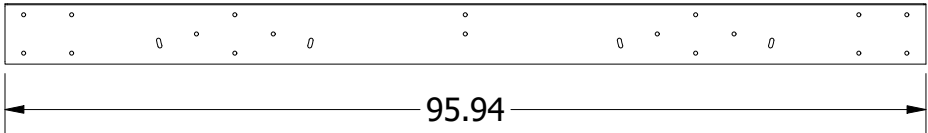

AM-64830

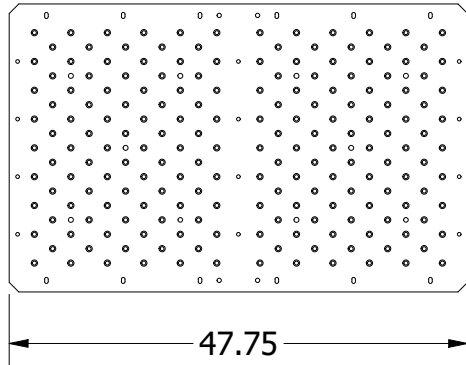

AM-30001

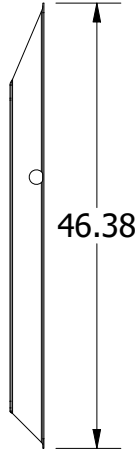

AM-30002

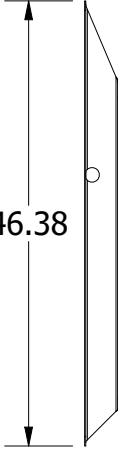

AM-20001

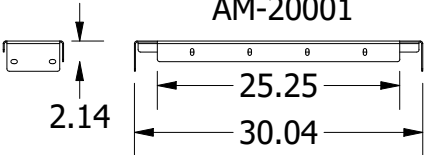

AM-20002

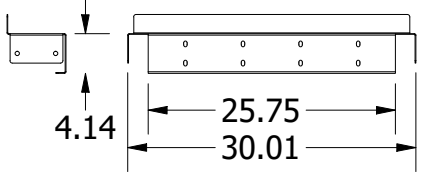

AM-20003

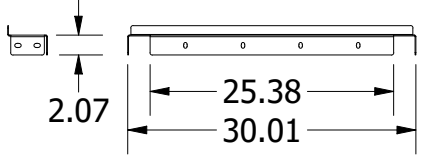

AM-20004

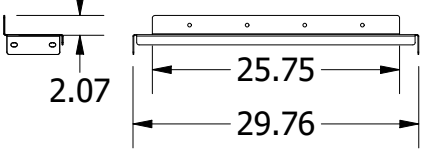

All connections use 3/8 hardware except tread plate 5/16.

AM-40001

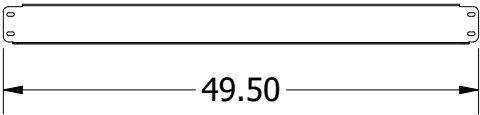

AM-62430

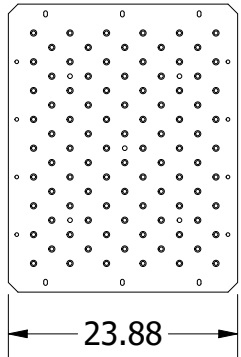

AM-40002

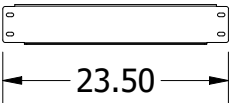

HRC1500



TR1509600

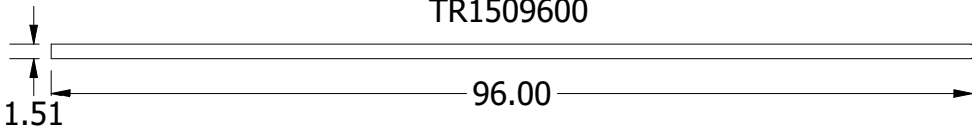

TR1510206

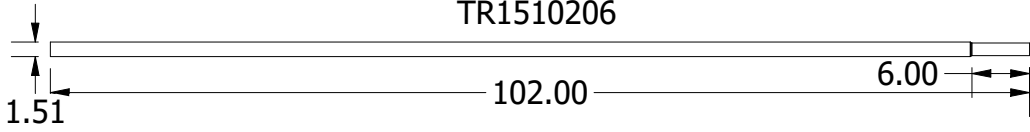

TR1009600

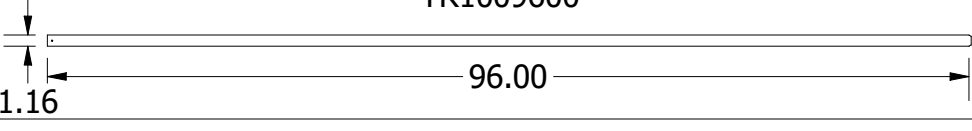

TR1010206

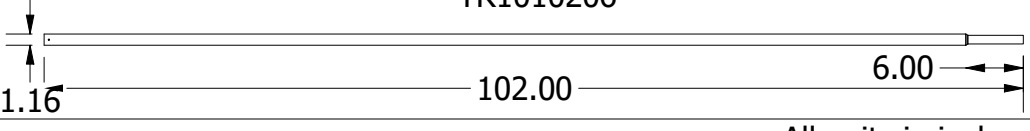

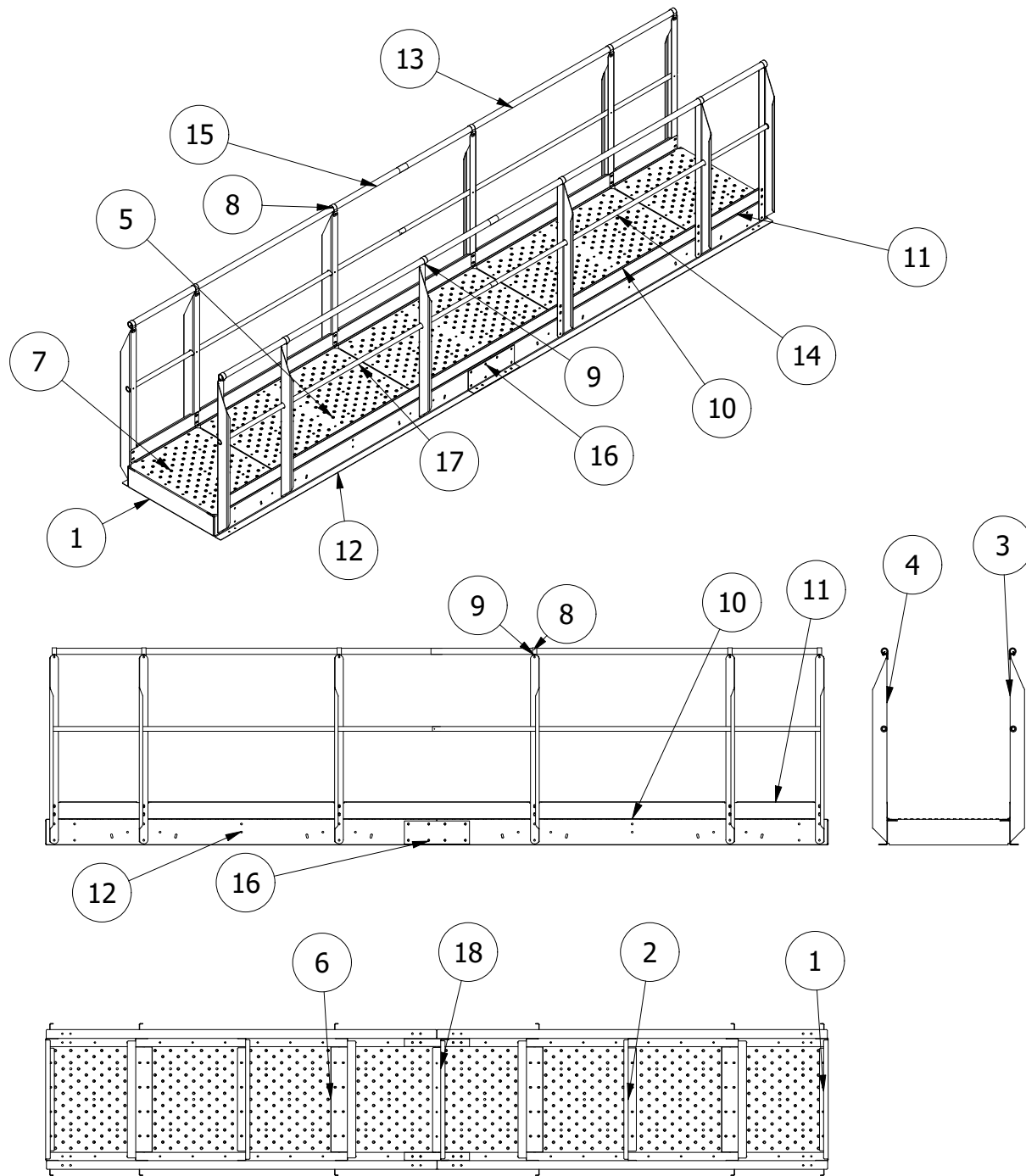

PARTS LIST			
ITEM	QTY	PART NUMBER	DESCRIPTION
1	2	AM-20001	End Cross Support
2	2	AM-20003	Mid Cross Support
3	6	AM-30001	Left Post
4	6	AM-30002	Right Post
5	3	AM-64830	Deck Tread, 48"X30"
6	4	AM-20002	Post Cross Support
7	2	AM-62430	Deck Tread, 24" x 30"
8	12	HRC1500	Handrail Clamp for 1.5 in
9	12	floor screw	self drilling
10	6	AM-40001	48" kickboard
11	4	AM-40002	24" kickboard
12	4	AM-06096	Z Rail,6"X2"X96"
13	2	TR1509600	96 in 1.5 in dia tubing no swage
14	2	TR1009600	96 in 1 in dia tubing No Swage
15	2	TR1510206	102 in 1.5 in dia tubing 6in swage
16	4	AM-50001	Z Rail Splice Plate
17	2	TR1010206	102 in 1 in dia tubing 6in swage
18	1	AM-20004	Splice Cross Support

STEP 1 : Z Rail and Mid Cross Support

PARTS LIST			
ITEM	QTY	PART NUMBER	DESCRIPTION
2	2	AM-20003	Mid Cross Support
12	4	AM-06096	Z Rail,6"X2"X96"

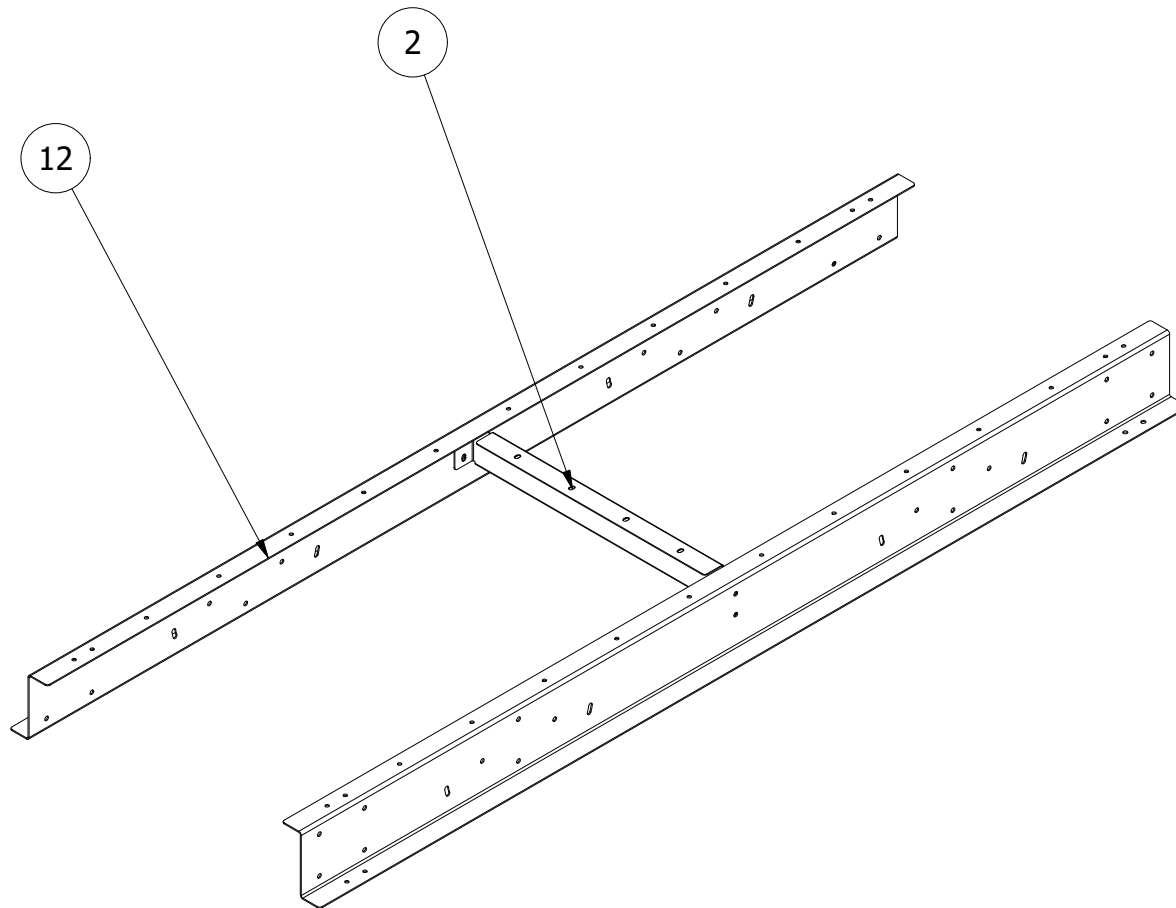

STEP 2 : Adding Cross Supports and Posts

PARTS LIST			
ITEM	QTY	PART NUMBER	DESCRIPTION
1	2	AM-20001	End Cross Support
3	6	AM-30001	Left Post
4	6	AM-30002	Right Post
6	4	AM-20002	Post Cross Support

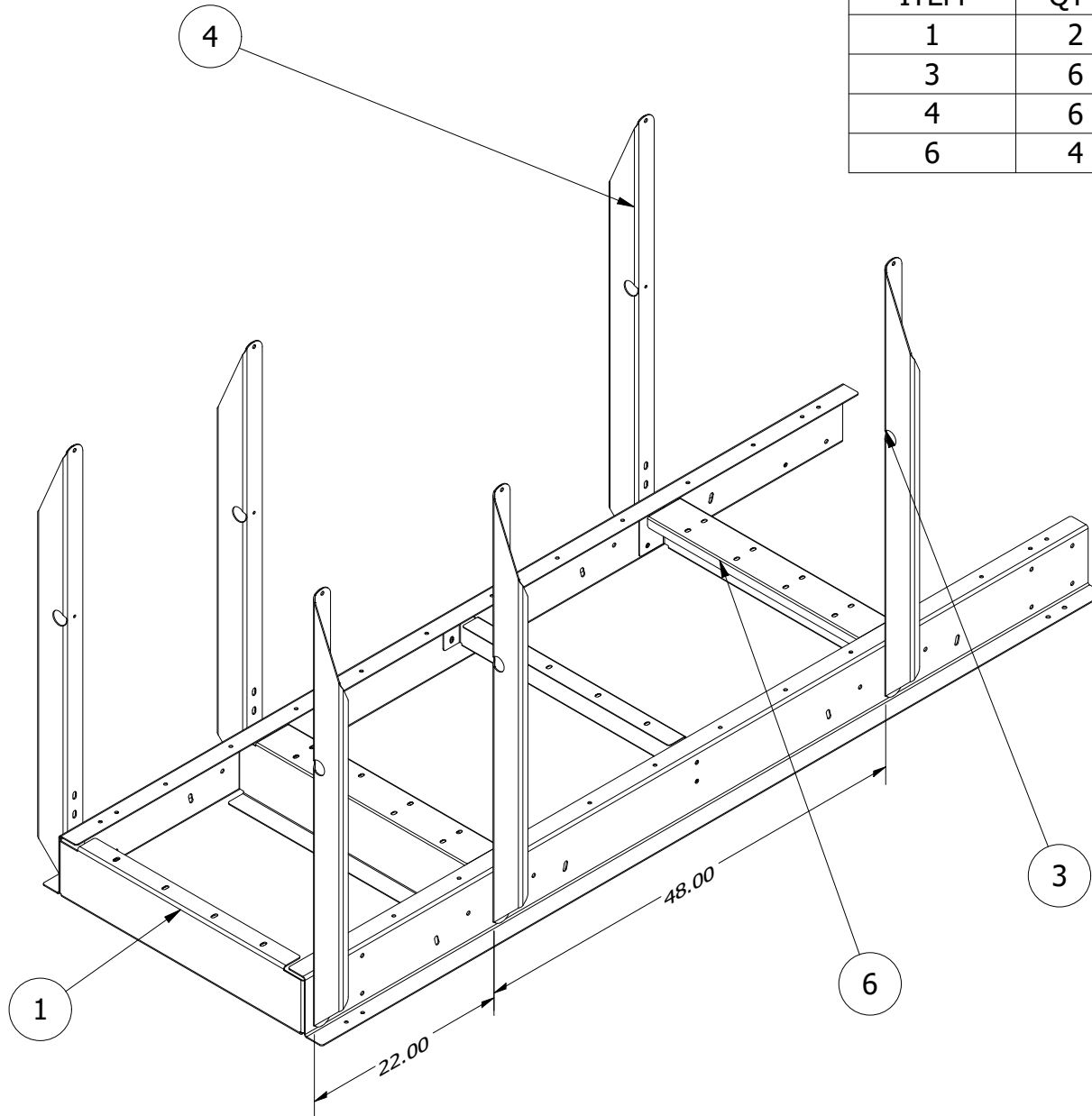

Note: All cross supports must be added along with the posts.

Leave connections loose until structure is assembled

STEP 3: Adding Z Rails, Z Rail Splice and Splice Cross Support

PARTS LIST			
ITEM	QTY	PART NUMBER	DESCRIPTION
12	4	AM-06096	Z Rail,6"X2"X96"
16	4	AM-50001	Z Rail Splice Plate
18	1	AM-20004	Splice Cross Support

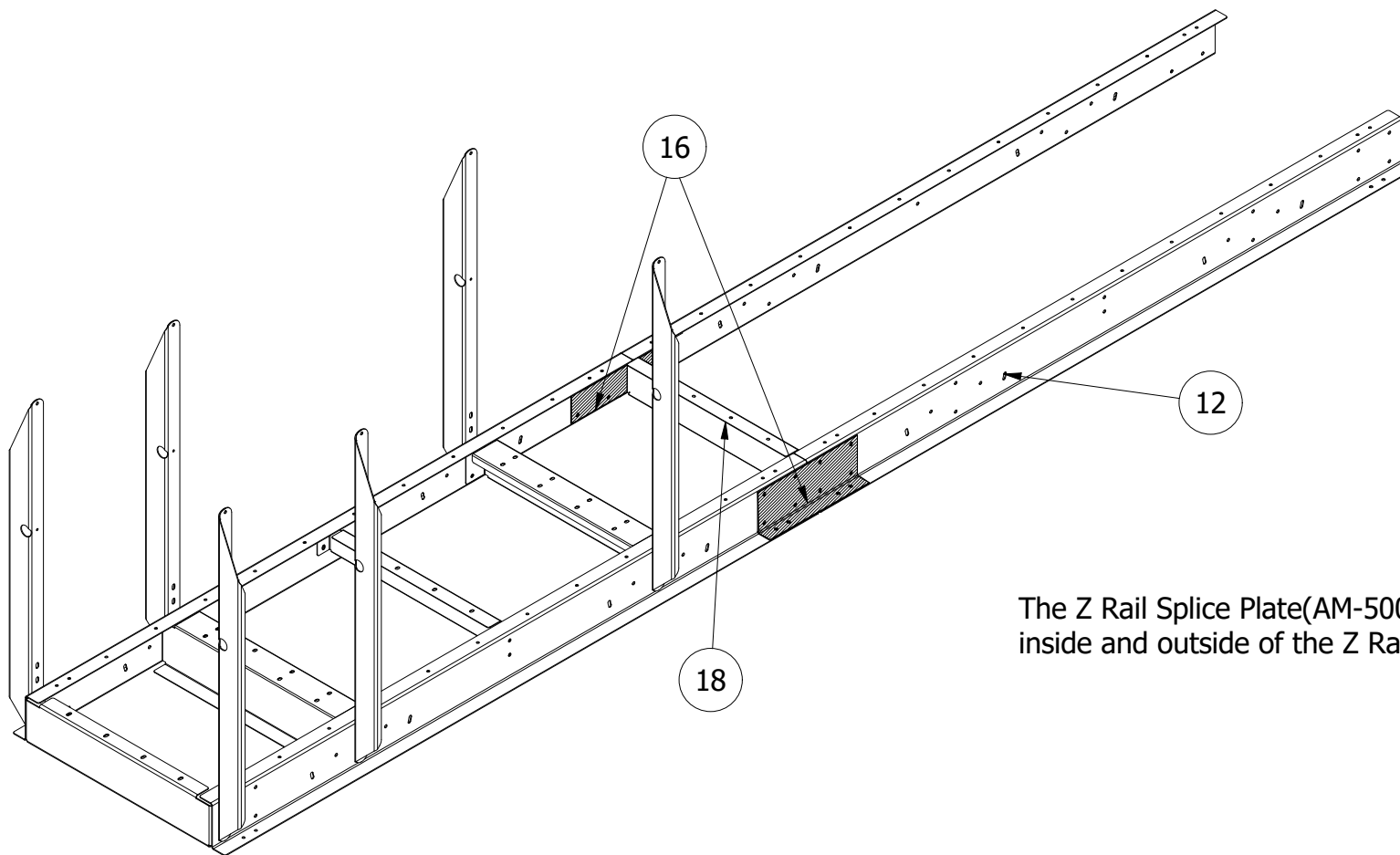

The Z Rail Splice Plate(AM-50001) goes on both the inside and outside of the Z Rail(Am-06096)

STEP 4: Add the remaining Posts and Cross Supports

PARTS LIST			
ITEM	QTY	PART NUMBER	DESCRIPTION
1	2	AM-20001	End Cross Support
2	2	AM-20003	Mid Cross Support
3	6	AM-30001	Left Post
4	6	AM-30002	Right Post
6	4	AM-20002	Post Cross Support

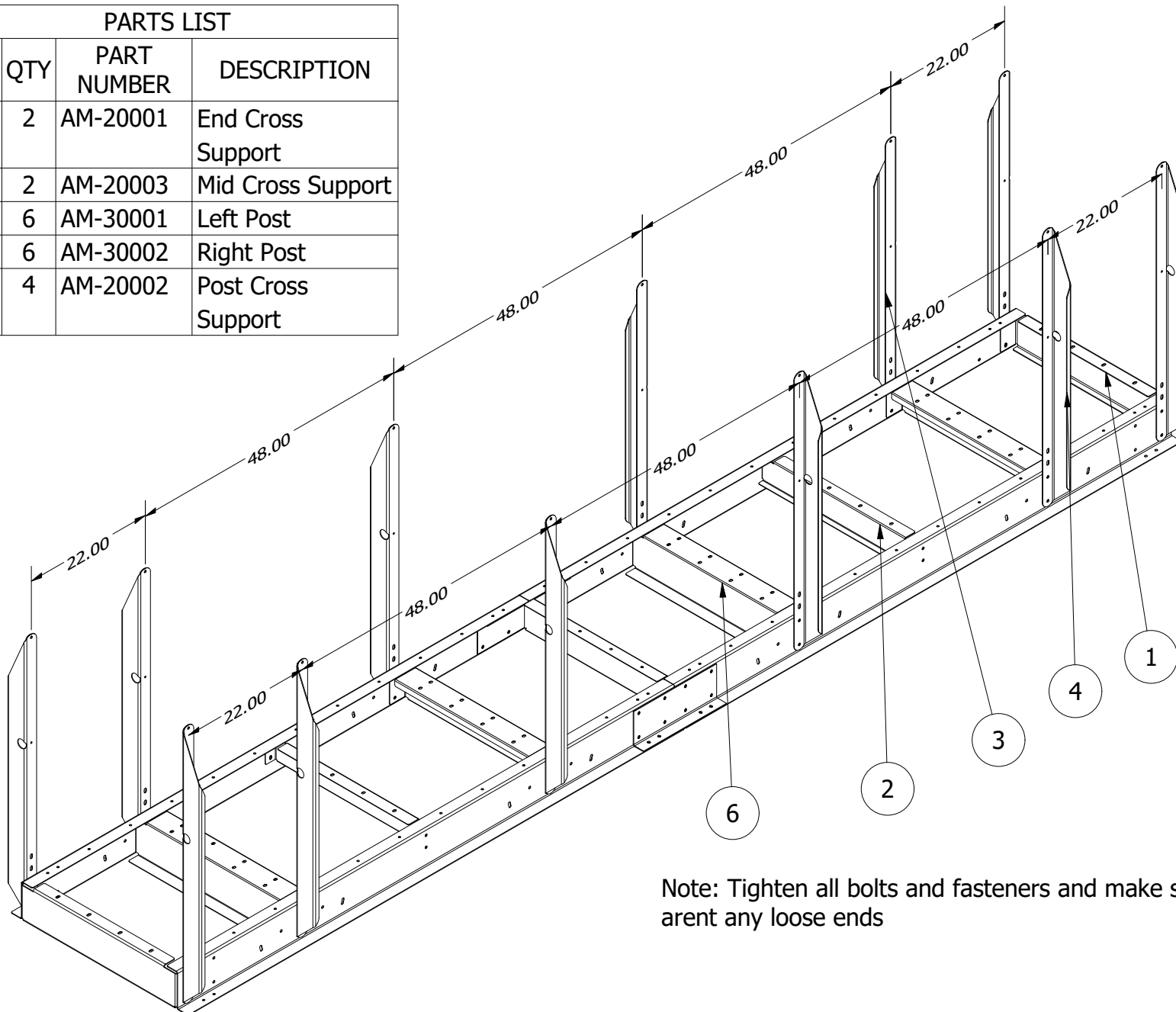

Note: Tighten all bolts and fasteners and make sure there arent any loose ends

STEP 5: Add the 48" and 24" Deck Treads

PARTS LIST			
ITEM	QTY	PART NUMBER	DESCRIPTION
5	3	AM-64830	Deck Tread, 48"X30"
7	2	AM-62430	Deck Tread, 24" x 30"

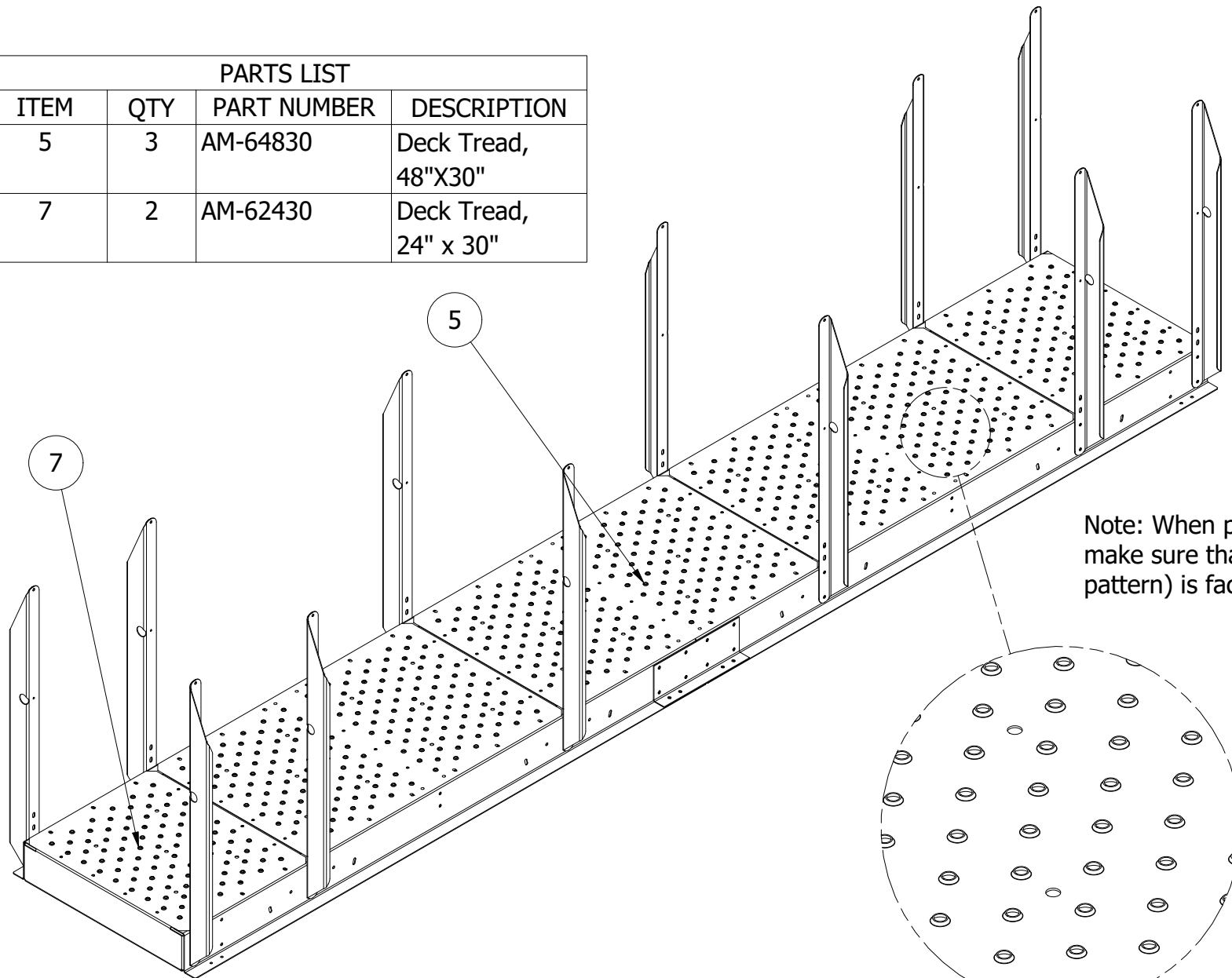

Note: When placing the decks make sure that the punch (raised pattern) is facing upward

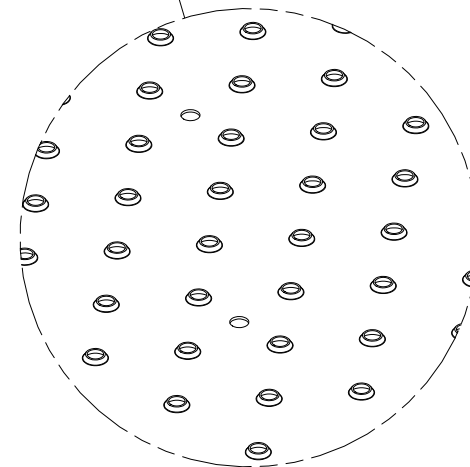

DETAIL

STEP 6 : Adding the Kick boards

PARTS LIST			
ITEM	QTY	PART NUMBER	DESCRIPTION
10	6	AM-40001	48" kickboard
11	4	AM-40002	24" kickboard

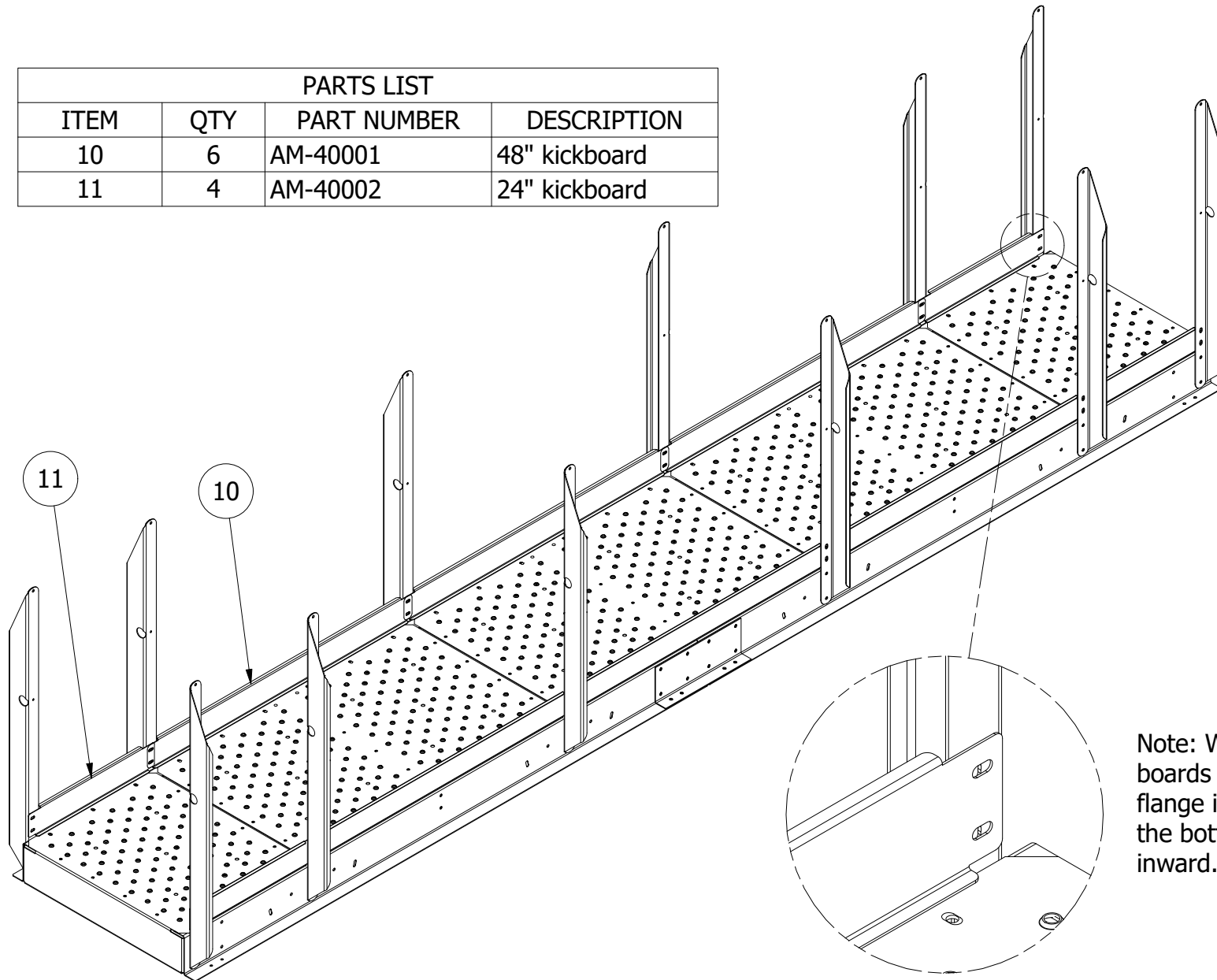

Note: When placing the kick boards make sure the top flange is facing outward and the bottom flange is facing inward.

DETAIL

Handrail Clamp Installation Instructions

Note: Roof Stair is not a part of this package, this sheet is only to assist in handrail clamp instructions

- Position the handrail clamp so it is oriented facing outward, and so it does not interfere into the width of the stairs or walkway.
- Insert the bolt through both holes on the handrail clamp first, then push the bolt through the hole in the stair post from the inside. Install the nut on the outside so that the bolt head is on the inside of the stairs.
- Fasten the clamp tightly together so it is closed around the handrail, making sure the post is not between the two tabs.
- Install a self-drilling screw into the handrail clamp and through the handrail. It should be positioned on the outside near the bottom, to minimize contact with the hands.

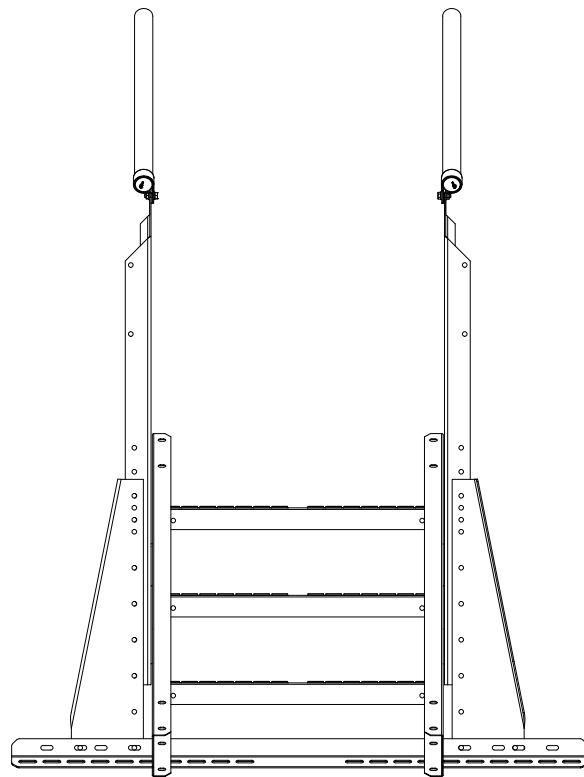

Roof Stair Example Shown

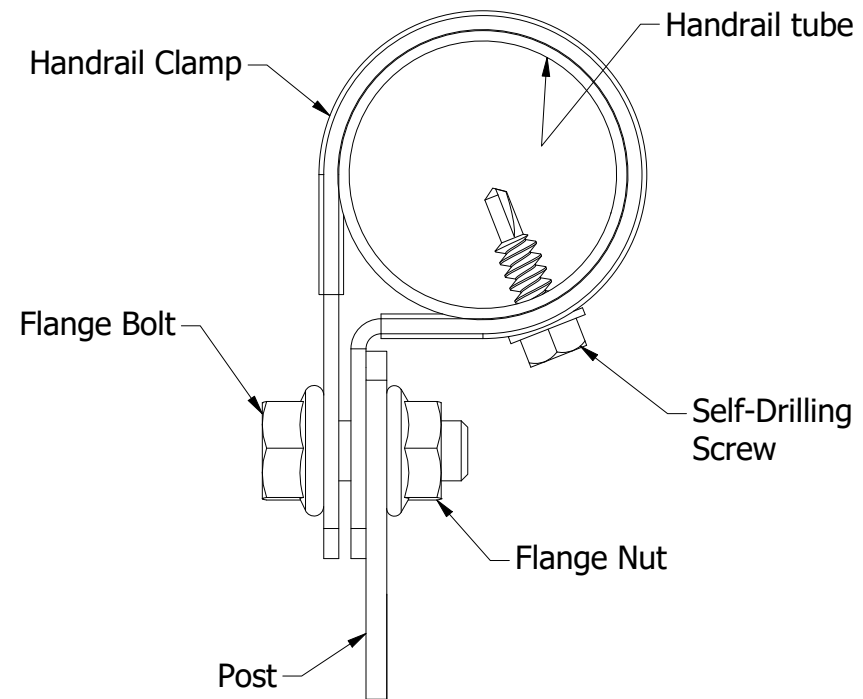

Detail of Handrail Clamp Assembly

STEP 7: Adding the tubing and handrail clamps

PARTS LIST			
ITEM	QTY	PART NUMBER	DESCRIPTION
8	12	HRC1500	Handrail Clamp for 1.5 in
9	12	floor screw	self drilling
13	2	TR1509600	96 in 1.5 in dia tubing no swage
14	2	TR1009600	96 in 1 in dia tubing No Swage
15	2	TR1510206	102 in 1.5 in dia tubing 6in swage
17	2	TR1010206	102 in 1 in dia tubing 6in swage

